



Driver: \_\_\_\_\_ Date: \_\_\_\_\_

Track/Event: \_\_\_\_\_

### Front Suspension



Ride Height: \_\_\_\_\_  
 Camber: \_\_\_\_\_° Toe: \_\_\_\_\_°  
 Ackerman:  Forward  Back

Servo:  Fwd  Back  
 Axles:  Trailing  Inline  
 Caster Block:  
 20°  25°  30°

# Washers \_\_\_\_\_



A B

Axle Height:

- High
- Med
- Low

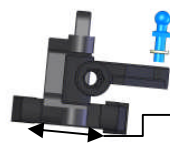

# Washers \_\_\_\_\_

Position:

- Fwd  Back

### Front Shocks

	Spring	Piston	Oil
AE			
Losi			
Kyosho			
HB			

Shock Length: \_\_\_\_\_

Compressed Length: \_\_\_\_\_

### Rear Suspension

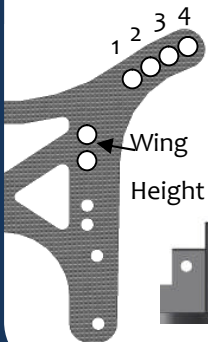

Ride Height: \_\_\_\_\_  
 Camber: \_\_\_\_\_°  
 Transmission Height: \_\_\_\_\_

Sway Bar: \_\_\_\_\_

Arm Position:

- Back  Mid  Fwd

# Washers \_\_\_\_\_

Wing

Height \_\_\_\_\_

E-Speed High

E-Speed Low

1 2

O

A B C

I M O



Anti-Squat:

Hub Position:

- Back  Mid  Fwd

### Rear Shocks

	Spring	Piston	Oil
AE			
Losi			
Kyosho			
HB			

Shock Length: \_\_\_\_\_

Compressed Length: \_\_\_\_\_

### Weight

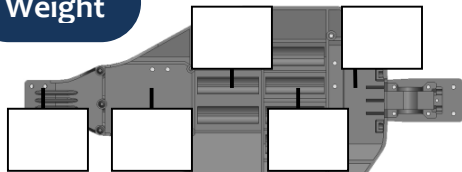

Total Weight: \_\_\_\_\_

F/R Bias: \_\_\_\_\_ / \_\_\_\_\_

### Notes/Rants/Excuses

Wing: \_\_\_\_\_

Battery: \_\_\_\_\_ Motor: \_\_\_\_\_ Gearing: \_\_\_\_\_ / \_\_\_\_\_